

# ZX-HM Series – Installation Guide

## Specifications

Excitation Voltage (Ve) ..... 5.00±0.25 VDC  
 Excitation Current ..... 21 mA Max.  
 Minimum Load Impedance .... 30KΩ  
 Linearity ..... ±1.0% Full Scale  
 Operating Temperature ..... -40°C to 100°C

## Electrical Cable Wiring

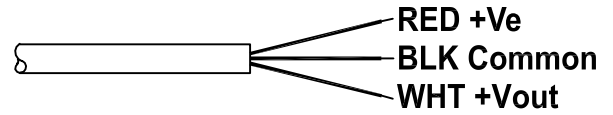

## Dimensional Information

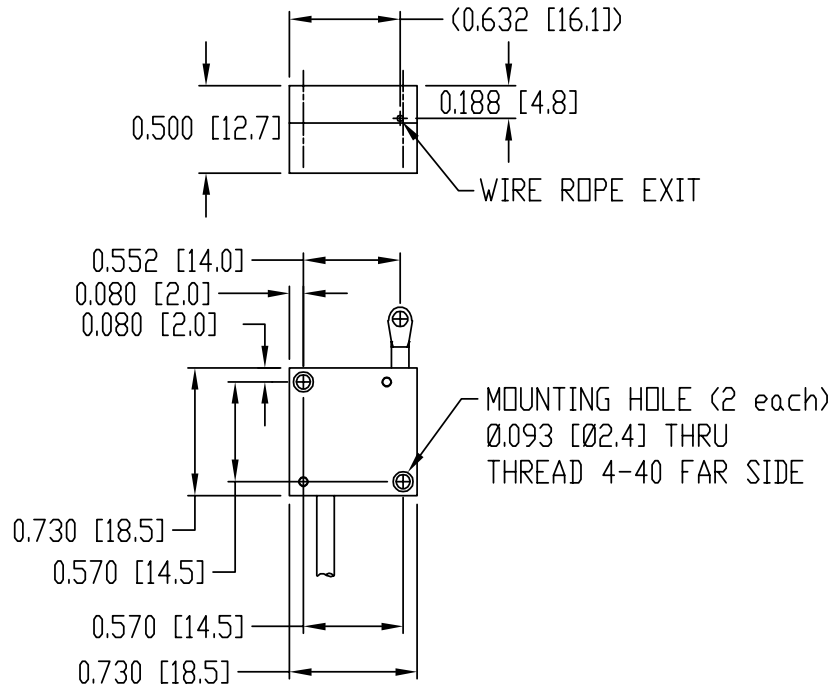

## OPTION A – Eye Fitting

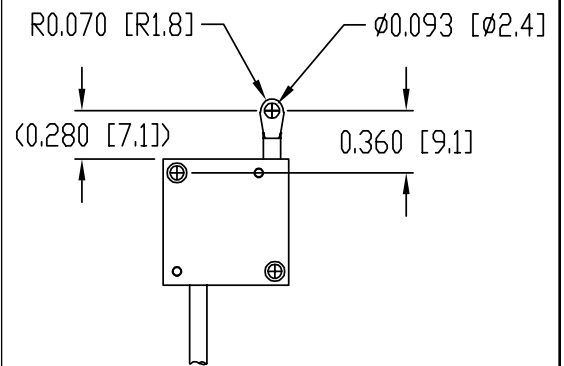

## OPTION B – Leader Wire Rope with Clip

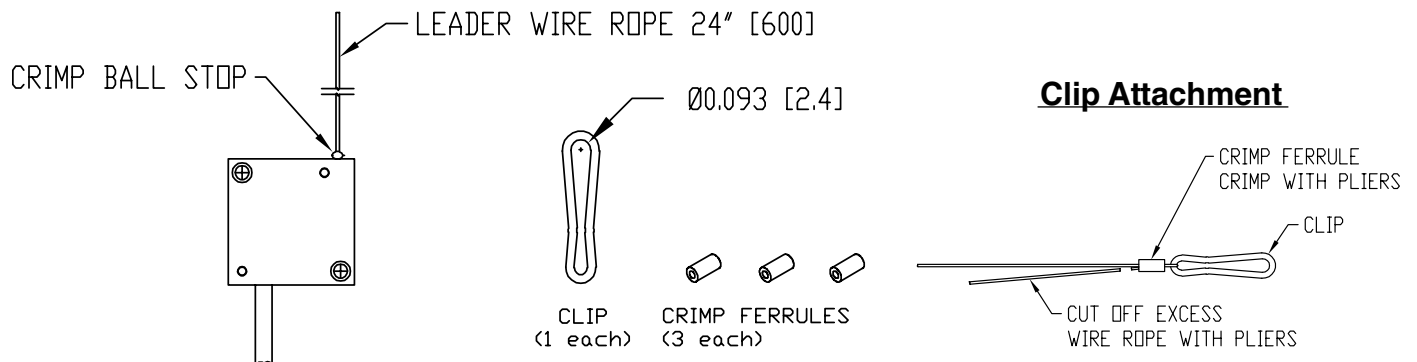

Dimensions in brackets are in millimeters

400276a.indd, 400276a.pdf